

EASI# _____

Pantry Cabinet with 3 Sections Template

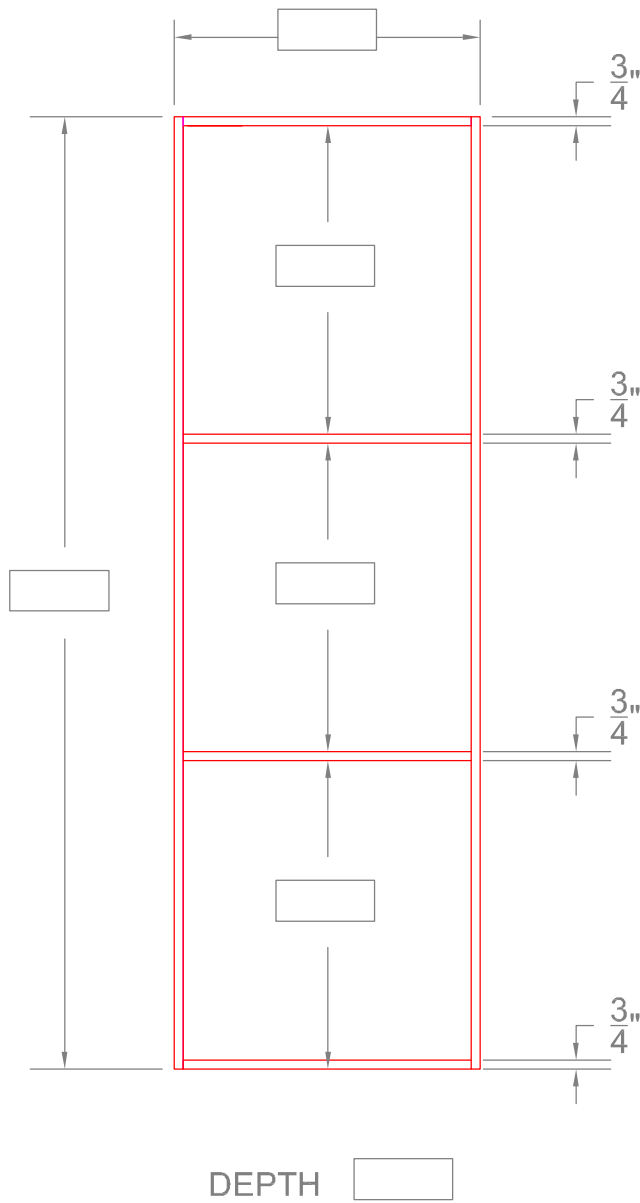

FRONT VIEW

NAME: _____

JOB: _____

DATE: _____

SELECT AN EASI SYSTEM HEIGHT

Section heights are the clear inside height between partitions or between a partition and the top or bottom.

Enter each section height required.

Matching a top section door height to a wall cabinet.

Use the wall cabinet height that you want to match. Subtract 1 1/8" from that height and enter it into the top section height box.